

Surface Mount Fuse with Holder, 12 x 5.2 mm, Quick-Acting F, 63 VAC, 63 VDC



UL 248-14 · 63 VAC · 63 VDC · Quick-Acting F



CCC

Description

- Directly solderable on printed circuit boards
- OMK 63 = OMF 63 + OMH 125

Standards

- UL 248-14
- CSA C22.2 no. 248.14

References

[Packaging Details](#)

Weblinks

[pdf](#), [html](#), [General Product Information](#), [Approvals](#), [RoHS](#), [CHINA-RoHS](#), [e-Shop](#), [SCHURTER-Stock-Check](#), [Distributor-Stock-Check](#)

Technical Data

Rated Voltage	63 VAC, 63 VDC
Rated Current	0.063 - 5 A
Breaking Capacity	50 A
Characteristic	Quick-Acting F
Mounting	PCB, SMT
Admissible Ambient Air Temp.	-40 °C to 85 °C
Climatic Category	40/085/21 acc. to IEC 60068-1
Material: Housing	Thermoplastic, UL 94V-0
Material: Terminals	Tin-Plated Copper
Unit Weight	0.48 g
Storage Conditions	0 °C to 60 °C, max. 70% r.h.
Product Marking	Type, Current, Approvals

Soldering Methods	Reflow
Solderability	245 °C / 3 sec acc. to IEC 60068-2-58, Test Td
Resistance to Soldering Heat	260 °C / 10 sec acc. to IEC 60068-2-58, Test Td

Dimensions

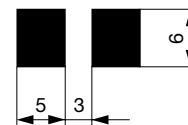
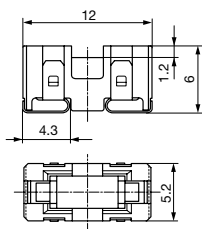
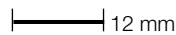

Soldering pads

Pre-Arcing Time

Rated Current I_n 1.0 x I_n min. 2.0 x I_n max. 4.0 x I_n max.

0.063 A - 5 A	4 h	1 s	10 ms
---------------	-----	-----	-------

Variants

Fuse	Holder	Rated Current [A]	Rated Voltage [VAC]	Rated Voltage [VDC]	Breaking Capacity	Voltage Drop 1.0 I _n typ. [mV]	Power Dissipation 1.0 I _n typ. [mW]	Melting I ² t 4.0 In typ. [A ² s]	CCC	Order Number
●	●	0.063	63	63	1)	2550	160	0.00011	●	3422.0003.xx
●	●	0.1	63	63	1)	1770	180	0.00067	●	3422.0004.xx
●	●	0.125	63	63	1)	1770	220	0.0011	●	3422.0049.xx
●	●	0.16	63	63	1)	1700	270	0.0018	●	3422.0005.xx
●	●	0.25	63	63	1)	990	250	0.0058	●	3422.0006.xx
●	●	0.35	63	63	1)	990	350	0.0076	●	3422.0043.xx
●	●	0.375	63	63	1)	990	370	0.013	●	3422.0044.xx
●	●	0.4	63	63	1)	960	380	0.016	●	3422.0007.xx
●	●	0.63	63	63	1)	290	180	0.02	●	3422.0008.xx
●	●	0.75	63	63	1)	260	200	0.031	●	3422.0046.xx
●	●	1	63	63	1)	220	220	0.078	●	3422.0009.xx
●	●	1.25	63	63	1)	220	280	0.14	●	3422.0010.xx
●	●	1.5	63	63	1)	200	300	0.24	●	3422.0047.xx
●	●	2	63	63	1)	200	400	0.44	●	3422.0012.xx
●	●	2.5	63	63	1)	190	480	0.97	●	3422.0013.xx
●	●	3	63	63	1)	190	570	1.3	●	3422.0014.xx
●	●	3.15	63	63	1)	190	600	1.2	●	3422.0048.xx
●	●	3.5	63	63	1)	140	490	1.6	●	3422.0015.xx
●	●	4	63	63	1)	140	560	2.1	●	3422.0016.xx
●	●	5	63	63	1)	140	700	2.9	●	3422.0017.xx

1) 50 A @ 63 VAC/DC

Packaging Unit

.xx = .11 Plastic Bag (100 pcs.)
 .xx = .23 Blister Tape 33 cm Reel (1500 pcs.)

Time-Current-Curves

